

Brownsville Public Utilities Board Water Tower Exhibit Expense Breakdown

Overall Budget Breakdown

- Total Request: \$47,000
- Tower and Slide: \$32,000 (68.1%)
- Fencing: \$15,000 (31.9%)

Tower and Slide Details

- Cost: \$32,000 (68.1% of the total request)
- Description: The tower and slide will be a key attraction in the outdoor learning garden, providing an engaging and interactive experience for visitors of all ages.
- Importance: This investment will encourage community involvement and foster a love for nature and sustainable practices. Water towers support water storage and distribution, water pressure regulation, emergency preparedness, demand management, system efficiency, water quality, and are icon landmarks.

Fencing for Exhibit

- Shared Cost: \$15,000 (31.9% of the total request). \$10,000 are contributed as part of the ARP Grant currently in place to support the Outdoor Learning Garden expansion.
- Description: The funding will go towards installing a durable and secure fencing system around the exhibit area of the outdoor learning garden.
- Importance: The fencing will ensure the safety of visitors and protect the flora and fauna within the exhibit, creating a controlled environment for learning and exploration.

Recap:

Our \$47,000 request for the expansion of the outdoor learning garden can be divided into two main categories: \$32,000 for the tower and slide, and a shared expense of \$15,000 for the fencing.

This investment will significantly enhance the educational experience for the community, promoting sustainability, environmental awareness, and community involvement.

We kindly request your support and partnership in making this project a reality. Together, we can create a vibrant and educational outdoor space that will benefit the entire community.

April 21, 2023

Brownsville Public Utilities Board
1425 Robinhood Drive
Brownsville, Texas 78520



Dear Ms. Estrella Solorzano / Mr. Ryan Greenfeld,

I hope this letter finds you well. The Children's Museum in Brownsville has been an integral part of the community for over 18 years, providing a safe and fun environment for children and families to learn and explore together. As our partner we are so proud of our ongoing relationship and commitment to our patrons, the museum is currently in the process of expanding our Outdoor Learning Garden to include an additional 3,000 square feet of space for visitors to enjoy.

We would like to present an opportunity for the Brownsville Public Utilities Board to consider helping us finish the construction of this expanded Outdoor Learning Garden. The new facility would include a shaded area with a new spiral tower and a slide for children to enjoy and play. The expansion has been partially funded by the City of Brownsville to increase tourism to the area and provide additional quality-of-life amenities for our patrons.

The Children's Museum of Brownsville would like to formally request a contribution of \$47,000 to help with the addition of a new spiral tower with a slide. This project would allow children to develop their motor skills, promote outdoor play, and encourage discovery through participation. We believe that this project would be a valuable addition to the community and all those who visit our museum.

Thank you for your time and consideration. We appreciate all of your support and ongoing generosity, and we look forward to continuing to work together to make Brownsville a better place for all.

Sincerely,

A handwritten signature in black ink that reads "Felipe Pena". The signature is written in a cursive style with a loop at the end.

Felipe Pena III
Executive Director
Children's Museum in Brownsville

Children's Museum of Brownsville – Outdoor Learning Garden

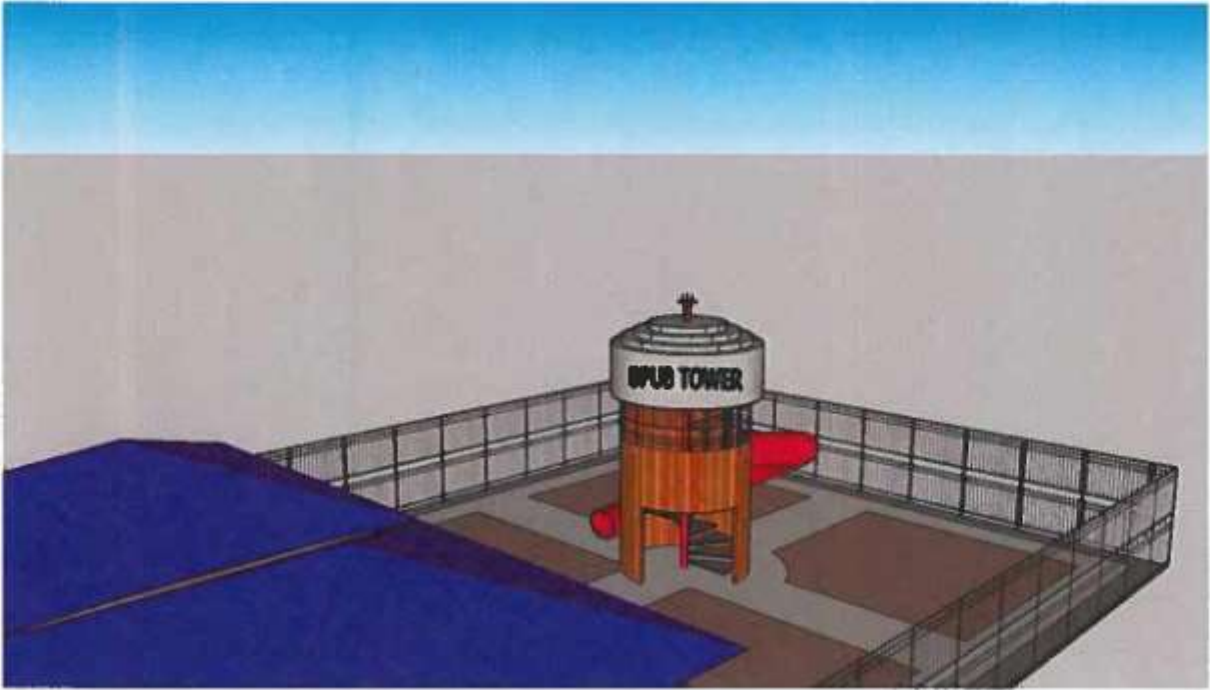

This exhibit features a BPUB water tower where children can climb to the top and slide down. Additional enhancement can include any specifics about how water towers work or why we use water towers.