

BROWNSVILLE PUBLIC UTILITIES BOARD ELECTRICAL ENGINEERING DEPARTMENT

LINE / EQUIPMENT DESCRIPTION	OVER OPEN LAND (FEET)	ALONG STREETS (FEET)
THREE PHASE OVERHEAD TRANSMISSION LINES (69,000-138,000 VOLTS)	50	25
THREE PHASE OVERHEAD DISTRIBUTION LINES (15,000 VOLTS)	30	15
SINGLE PHASE OVERHEAD DISTRIBUTION LINES (7,200 VOLTS)	20	10
UNDERGROUND DISTRIBUTION LINES (7,200 TO 15,000 VOLTS)	20	10
SERVICE LINES (120 - 480 VOLTS)	10	5
PAD MOUNTED TRANSFORMERS	20 X 20	10 X 20
PAD MOUNTED SWITCHGEAR	20 X 30	10 X 30

**EXAMPLE #1
UNDERGROUND**

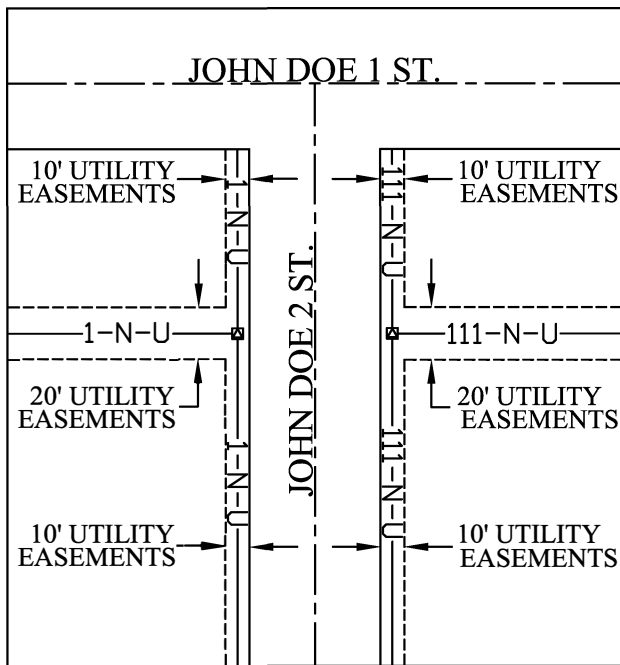

**EXAMPLE #2
OVERHEAD**

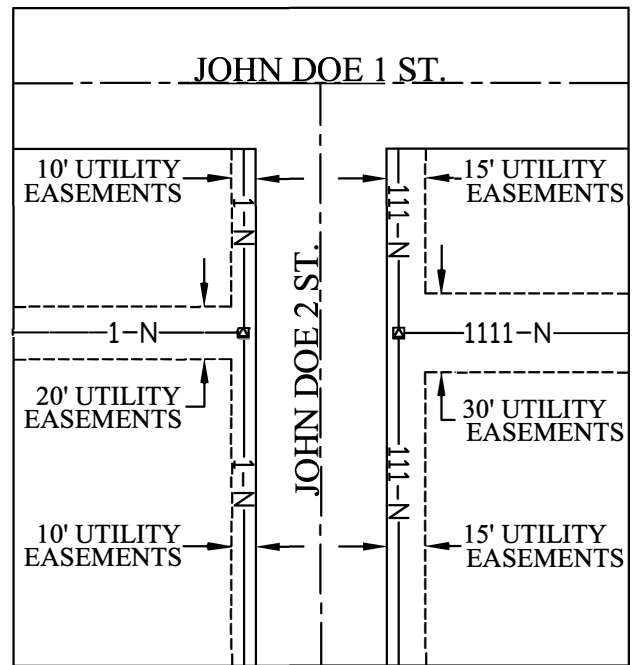

NOTE:

1. ADDITIONAL EASEMENTS MAY BE NEEDED.
2. ANY PROPOSED STRUCTURE (FENCE, SIDEWALK, ETC.) WITHING THE EASEMENT IS SUBJECT TO REVIEW AND APPROVAL BY BPUB.



ELECTRICAL EASEMENT REQUIREMENTS

DEVELOPED BY:

STANDARDS
COMMITTEE

APPROVED:

MAY 2023

DRAWING
NUMBER

ENG-2

