

**BROWNSVILLE PUBLIC UTILITIES BOARD
ELECTRICAL ENGINEERING DEPARTMENT**

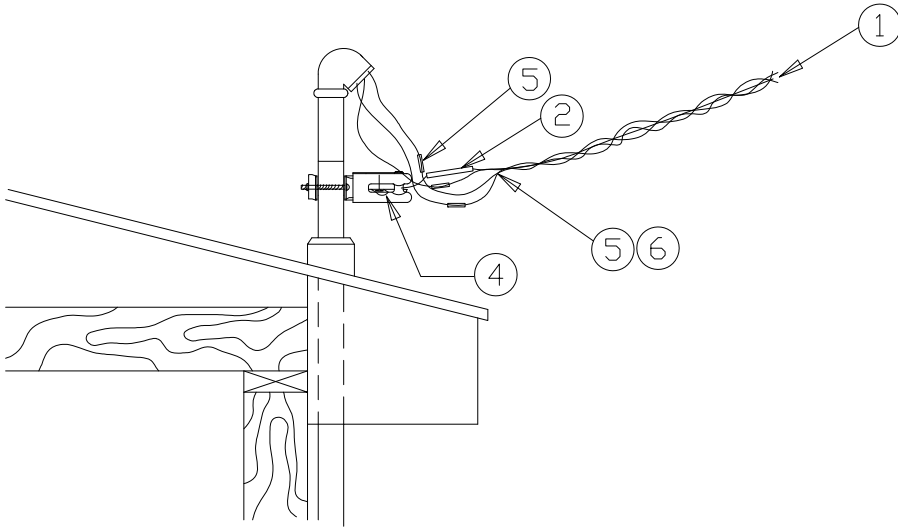

NOTES:

1. TRIPLEX OR QUADRUPLIX SERVICE DROP CABLE.
2. CABLE GRIP.
3. CLEVIS TYPE WIREHOLDER WITH INSULATOR (SIMILAR TO CHANCE # 0912) PROVIDED AND INSTALLED BY CUSTOMER.
4. SERVICE TYPE WIREHOLDER (SIMILAR TO CHANCE C207-0075)
5. SERVICE ENTRANCE SLEEVES
6. PLASTIC COVERS FOR HOT LEGS IF NON-INSULATED SERVICE ENTRANCE SLEEVES ARE USED
7. ON 4 WIRE QUADRUPLIX SERVICES, THE COVERED CONDUCTOR WITH MOST NUMBER OF RIBS WILL BE CONNECTED AS THE "WILD LEG".
8. POINT OF ATTACHMENT FOR SERVICE MUST BE OF SUFFICIENT HEIGHT TO MAINTAIN, FOR THE SERVICE, 12' MINIMUM CLEARANCE TO GROUND, 18' MINIMUM TO COMMERCIAL DRIVEWAY AND 22' MINIMUM TO STREET.

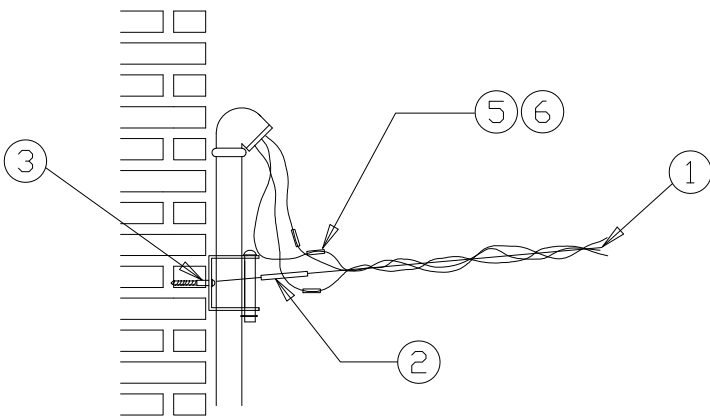

**STANDARD DISTRIBUTION CONSTRUCTION
STANDARD PRACTICE FOR USE OF
ALUMINUM TRIPLEX SERVICE DROP CABLE**

E-1

DEVELOPED BY:

STANDARDS
COMMITTEE

APPROVED:

SEP 2020

DRAWING
NUMBER

STD D-102

