



B R O W N S V I L L E
PUBLIC UTILITIES BOARD

Date: September 12, 2022
To: All Vendors
Subject: Addendum #1

REFERENCE: B071-22 Lift Station for River Woods Subdivision and Surrounding Areas

This Addendum forms part of the contract and clarifies, corrects or modifies original bid document.

See attached design revisions.

The signature of the company agent, for the acknowledgement of this addendum, shall be required. **Complete information below and return via e-mail to: dsolitaire@brownsville-pub.com.**

I hereby acknowledge receipt of this addendum.

Company: _____

Agent Name: _____

Agent Signature: _____

Address: _____

City: _____ **State:** _____ **Zip:** _____

Phone Number: _____ **E-mail address:** _____

If you have any further questions about the Bid, call 956-983-6366.

BY: ***Diane Solitaire***
Purchasing

Project Addendum No.1

Project:	Lift Station for River Woods Subdivision and Surrounding Areas BPUB Bid No. B071-22	Addendum Date:	September 12, 2022
From:	John W. Clint, PE	Project No.:	45857.001

ADDENDUM No. 1

DESIGN REVISIONS

1. Sheet 8 – Structural delegated design note on sheet E4.00 has been replaced by the detail labeled “Typical Rack Support & Roofing Detail” for the proposed electrical equipment rack & canopy.

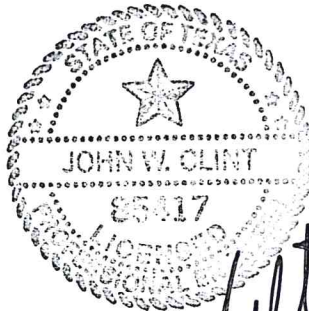

John W. Clint
09/12/22

S:\45000a_4857\001\CADD\Sheet\BRO Lift Station\C-DETAILED-4857.D01-FM.dwg Sep 12, 2022 - 1:33pm

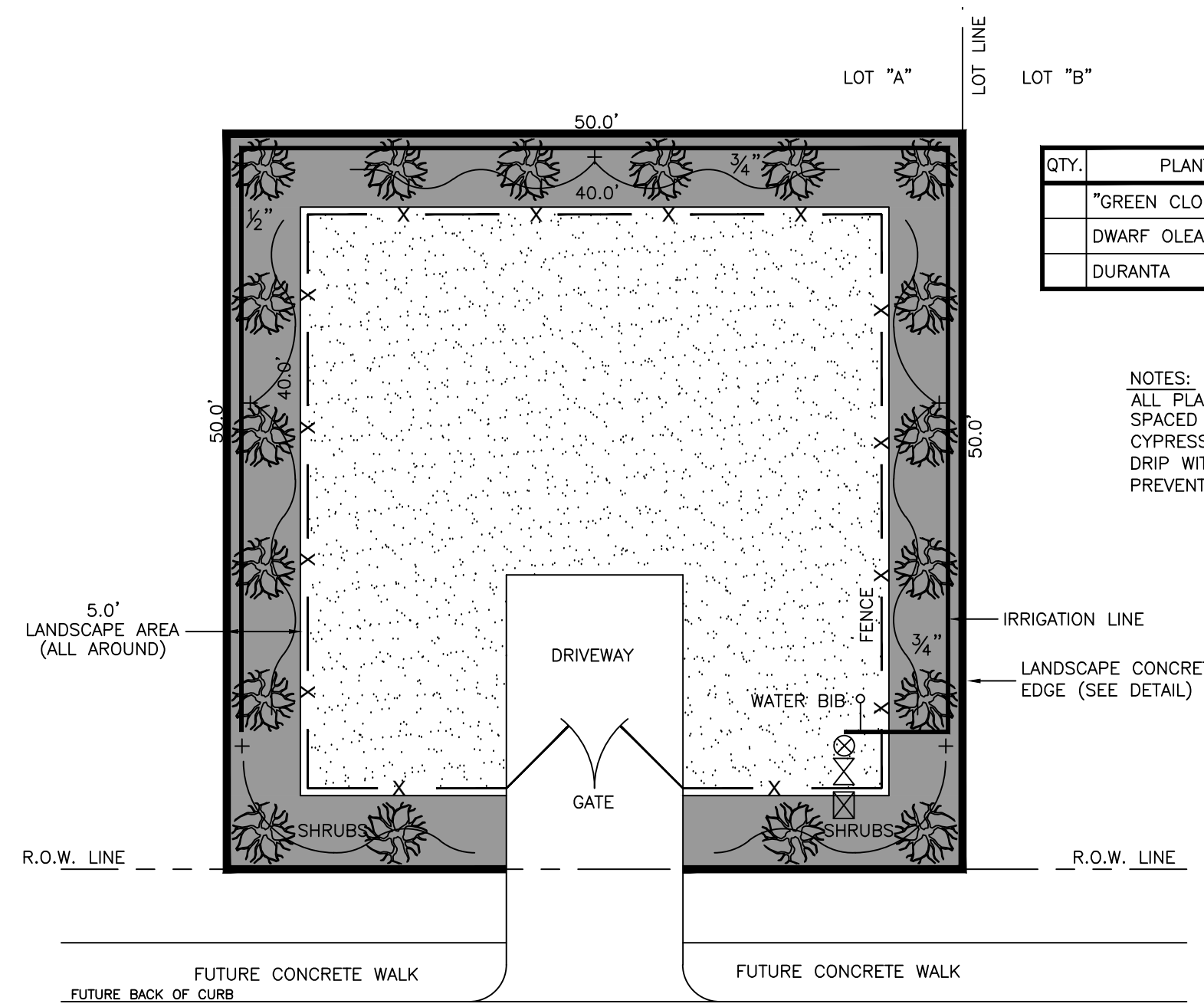

LIST OF RECOMMENDED SHRUBS

QTY.	PLANT	BOTANICAL NAME
	"GREEN CLOUD" SAGE CENIZO	LEUCOPHYLLUM FRTESCENS, "GREEN CLOUD"
	DWARF OLEANDER	NERIUM OLEANDER
	DURANTA	NATIVE TURKS CAP OR SIMILAR

NOTES:
 ALL PLANTS SHALL BE 5 GAL., 18" BUSH HEIGHT (MIN) SPACED AT 4-FOOT CENTERS.
 CYPRESS MULCH 3" MINIMUM.
 DRIP WITH 1 ZONE BATTERY CONTROLLER, 1" PVB BACKFLOW PREVENTER/TESTED.

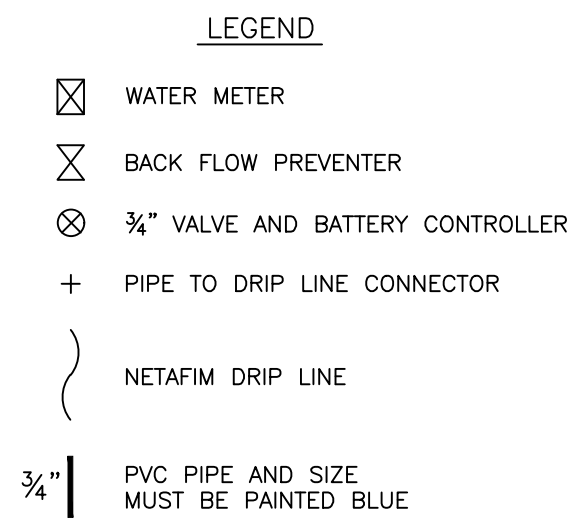

TYPICAL LIFT STATION LANDSCAPING PLAN

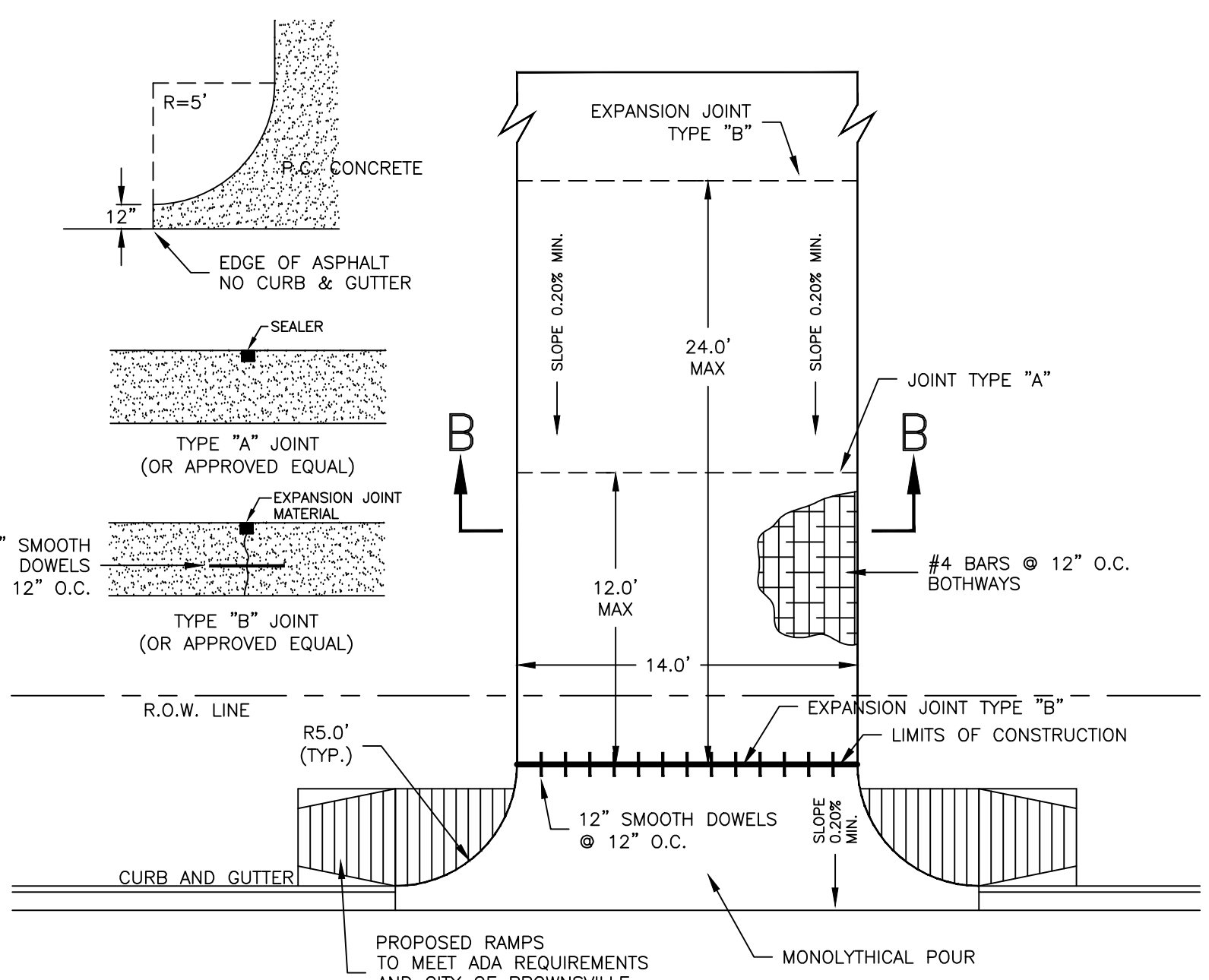

TYPICAL LIFT STATION DRIVEWAY

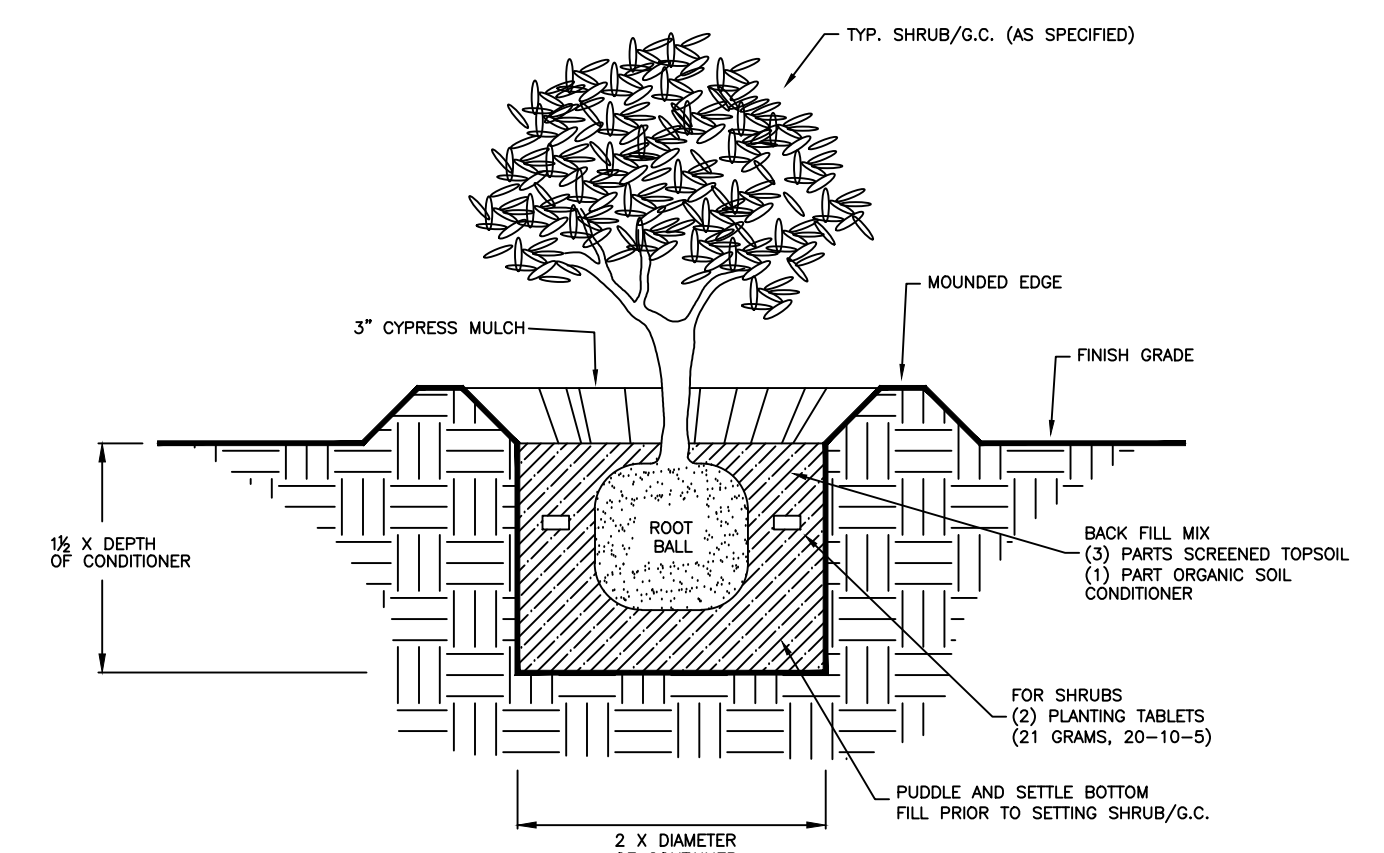

SHRUB/G.C. PLANTING DETAIL

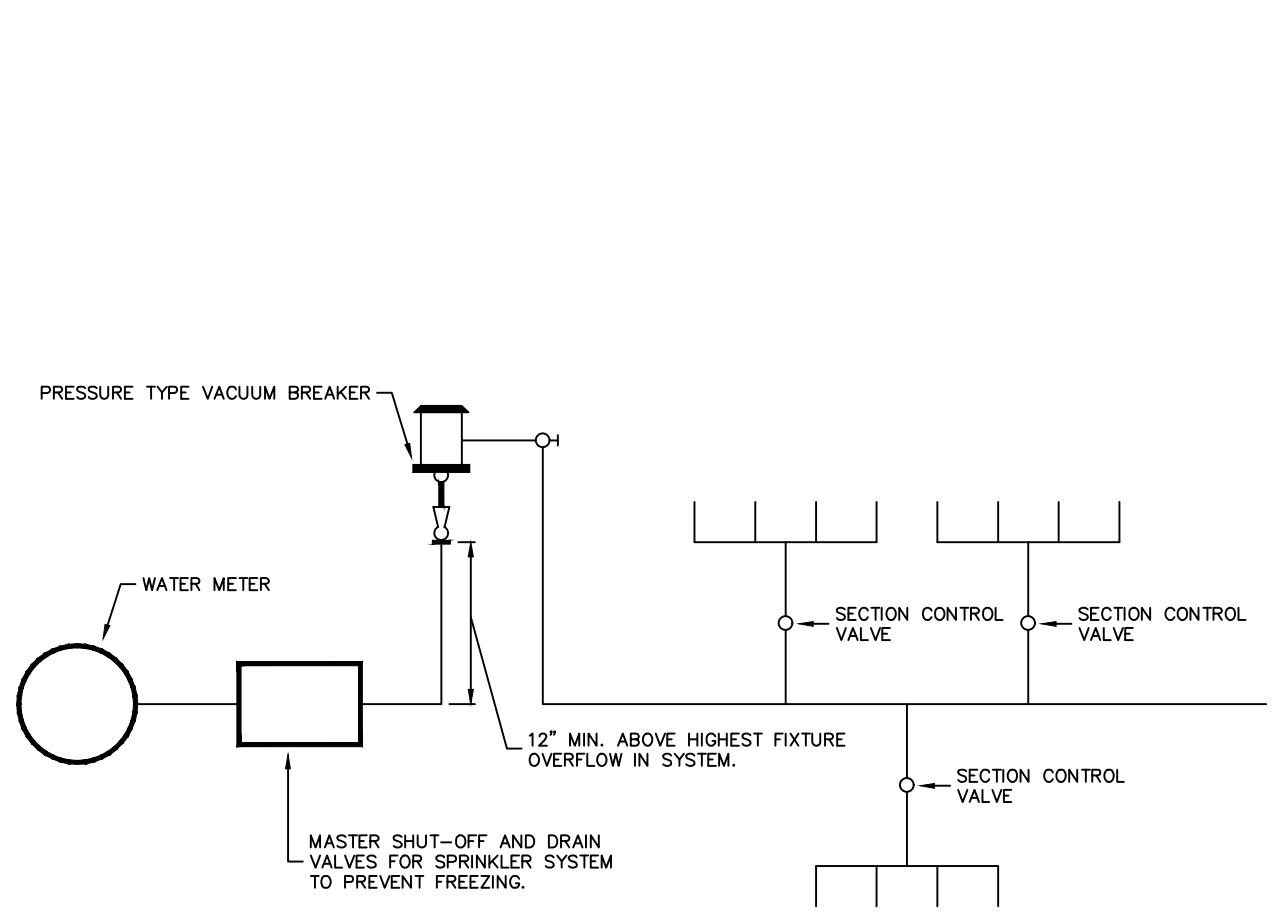

LAWN SPRINKLER INSTALLATION

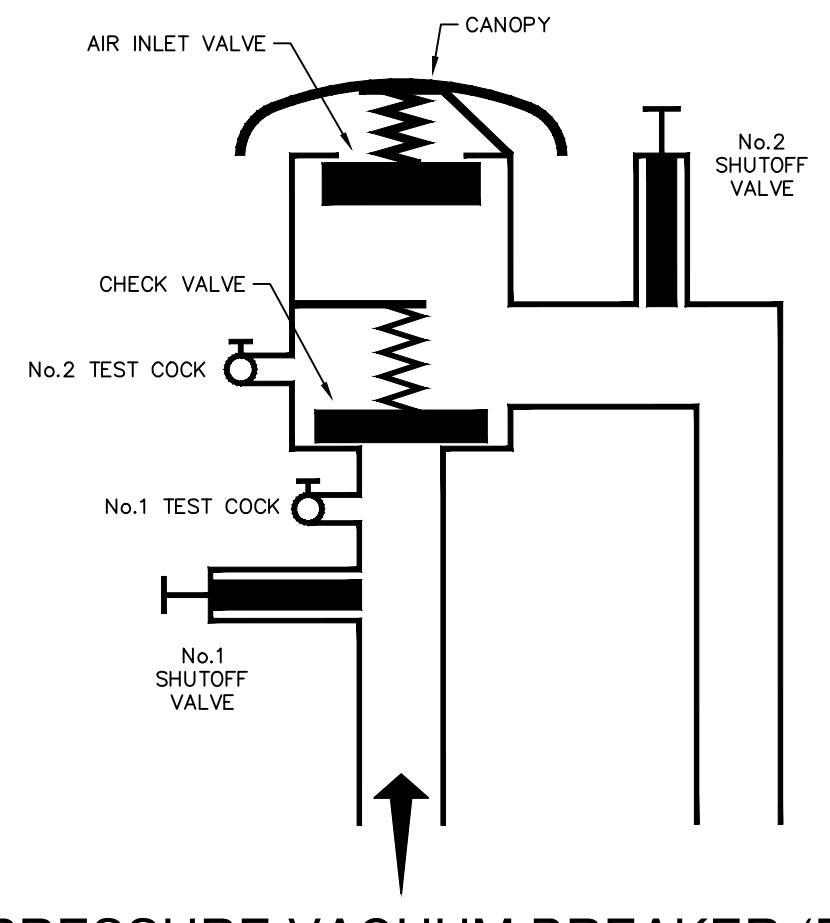

PRESSURE VACUUM BREAKER (PVB) BACKSIPHONAGE PREVENTION ASSEMBLY

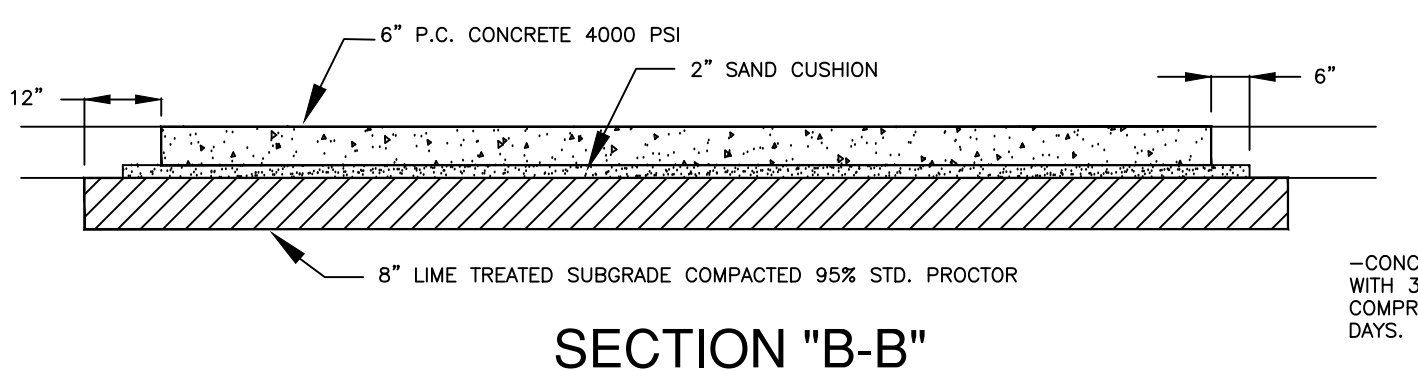

SECTION "B-B"

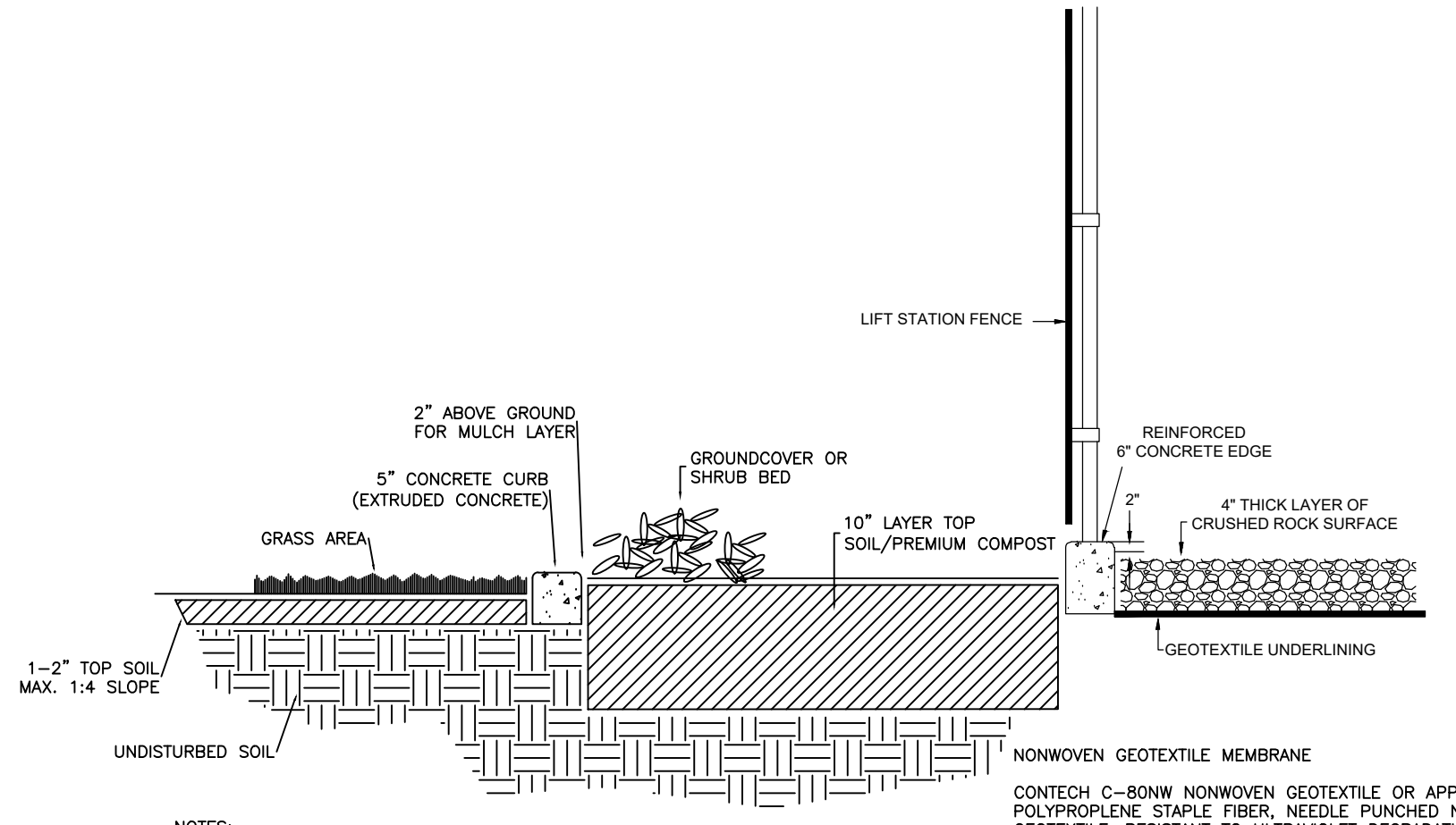

CONCRETE EDGE DETAIL

- NOTES:
- CONCRETE CURBING TO HAVE 1 1/2" DEEP CONTRACTION JOINTS @ 5'-0" SPACING.
 - 2500-3000 PSI COMPRESSIVE STRENGTH, 480 PSI FLEXURAL STRENGTH.
 - PROVIDE TAPERED DRAINAGE POINTS @ 10'-0" O.C. SPACING.
 - USE HALF-INCH POLYPROPYLENE FIBER REINFORCEMENT.
 - NATURAL FINISH AND COLOR.
 - EQUAL TO "CURB APPEAL" EDGING.

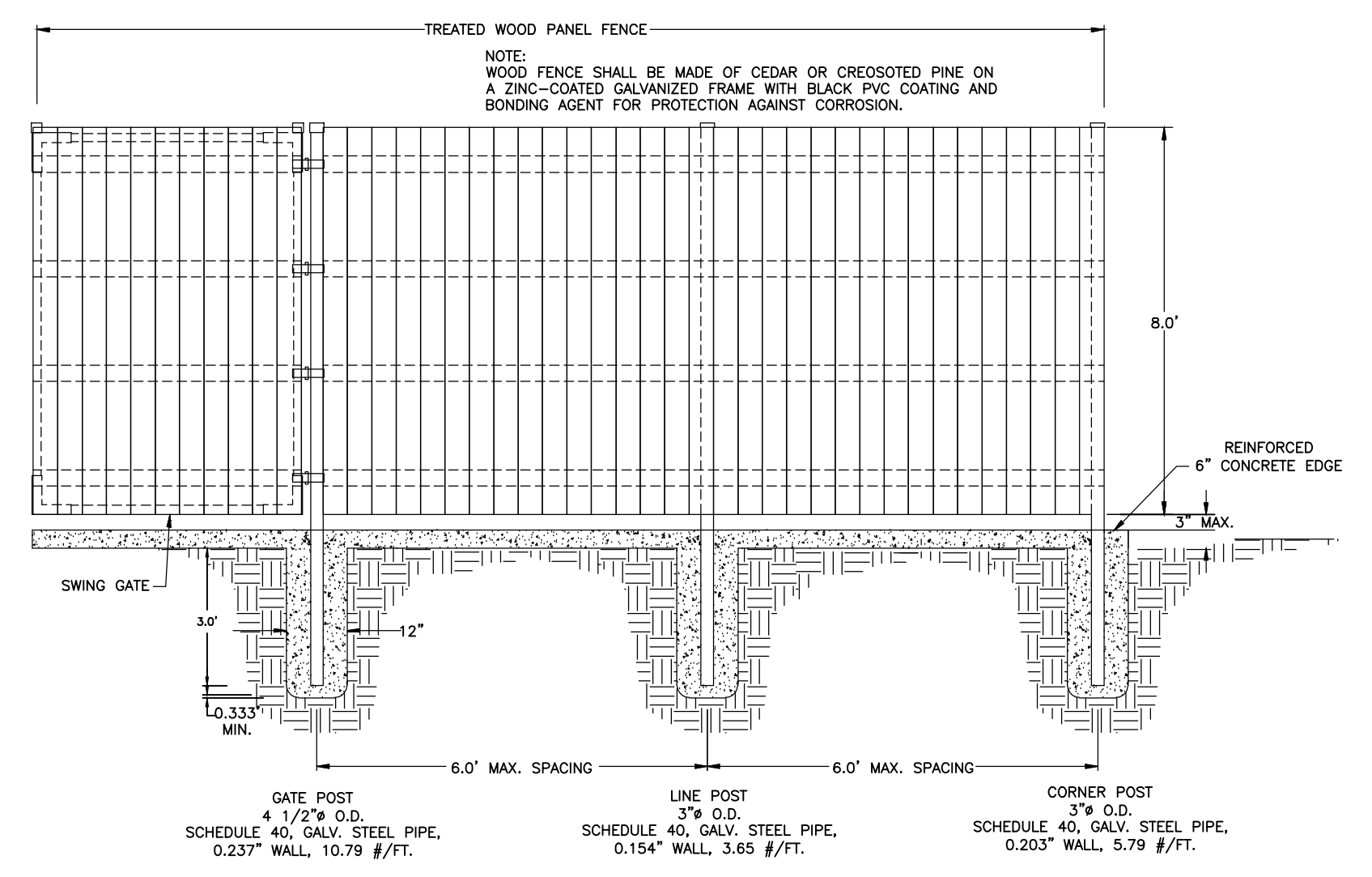

LIFT STATION FENCE DETAIL

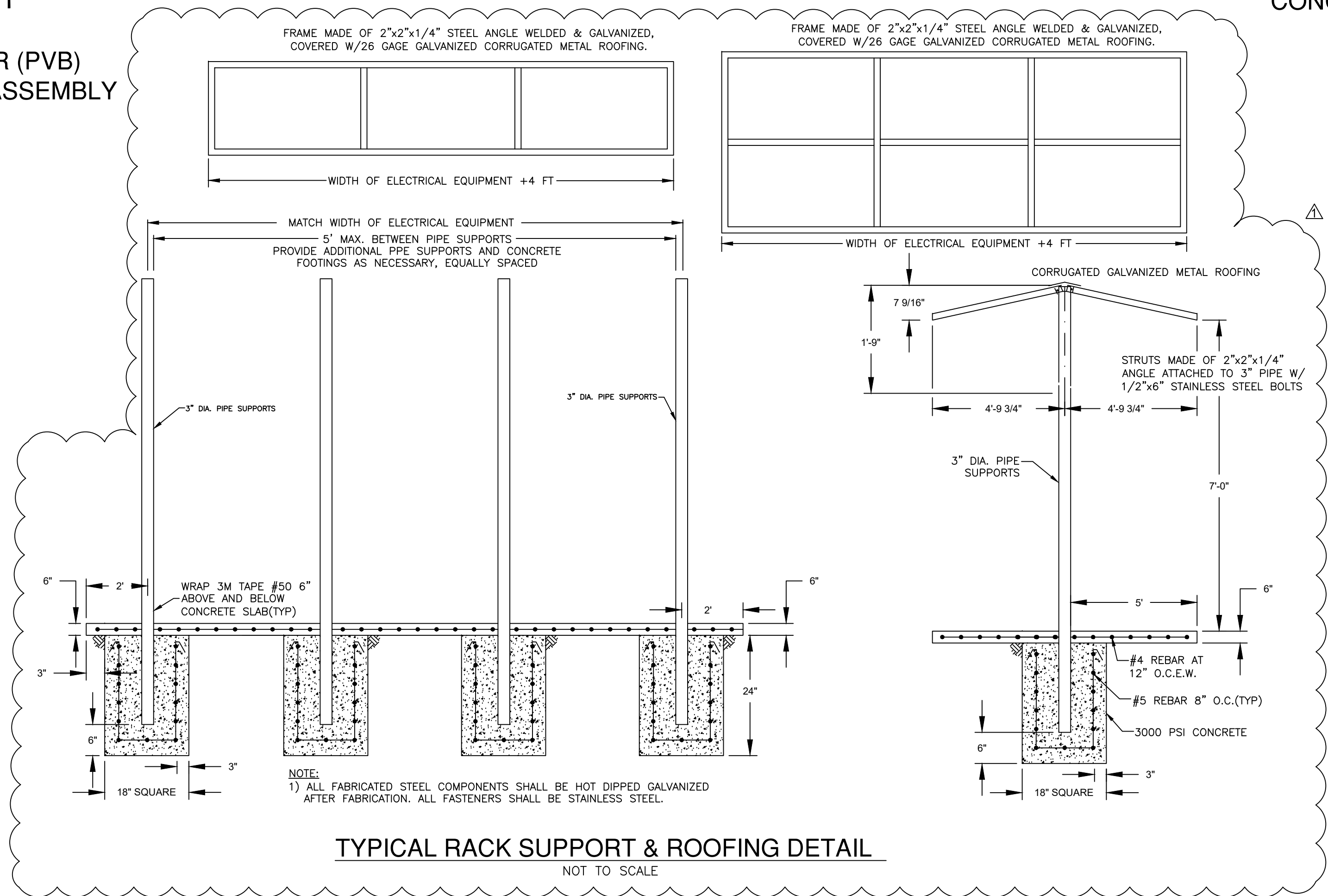

TYPICAL RACK SUPPORT & ROOFING DETAIL

NOT TO SCALE

LIFT STATION FOR RIVER WOODS
 SUBDIVISION AND SURROUNDING AREAS
 BROWNSVILLE, TEXAS

HALFF
 1025 PAREDES LINE ROAD, SUITE B
 BROWNSVILLE, TEXAS 77820
 TEL: 361.833.8888
 TEXELS ENGINEERING FIRM #312

Revision No.	Date	Description
1	9/12/2022	ADDENDUM 1-CANOPY DETAIL

JOHN W. CLINT
 09/12/22

Project No.:	4857.001
Issued:	8/22/2022
Drawn By:	MH
Checked By:	JWC
Scale:	AS NOTED
Sheet Title	LIFT STATION FENCE DETAILS
Sheet Number	8